



THERMAFLEX® VINYL SWING DOORS

THERMAFLEX® VINYL SWING DOORS: THE CLEAR ALTERNATIVE

- Easy-to-clean, clear vinyl material provides high visibility.
- Will not drag across product or snag on personnel or carts.
- Gravity hinge closes door quickly but gently.
- Exclusive adjustable cam block assures that the open door swings back to center position, even if the door jamb is out of line.
- Strong, versatile hinge adapts to all door widths; no waiting for special orders.
- Meets Sanitary Codes. Vinyl materials meet USDA/ FDA, NSF and local standards.
- Low temp curtains are standard for all applications.
- 10 year rust-proof hinge warranty.
- Temperature range of -30° to 125°.



SURE SWING HINGE

Strong, stainless steel hinge and roller easily swings vinyl door opened and closed; adapts to all door widths.

SPECIFICATIONS

MATERIAL:	DOOR OPENINGS:	SPECIAL APPLICATIONS:
CLEAR PVC, .105 GAUGE	30" TO 72" WIDE 72" TO 96" HIGH	HEAVY DUTY HINGES AVAILABLE FOR WIDE DOORS
TEMPERATURE RANGE: -30° TO 125°		



ThermalFlex® Easimount® System

Unique strip curtain system simplifies assembly and mounting.



Easimount® Installs in no time. Saves on labor. Mount the light weight aluminum track. Snap sturdy plastic glides onto strips. Slide strips onto track.

Rugged Novel mounting system prevents tear-out. Easimount provides several times the tear-out resistance of conventional systems.

Sanitary One piece, self-draining rail cleans quickly and prevents trapping of food and debris.

Flexible Strong extruded aluminum track accepts strips in widths from 4 inches to 12 inches and up to 12 feet long. Mix and match material. Change your strip widths as needed; even mix widths.

Good looking Sleek, streamlined mounted strip door looks as good as it works.

Use the Easimount system with the following ThermalFlex® strip materials: Nos. 401, 402, 403, 406, 407, 408, 409 and 410.



NSF-listed curtain available. Specify when ordering.

Mounting System U.S. Patent No. 5520237

Figure your energy and \$ savings with Easimount Strip Systems

Opening Size	KWH Use Before Easimount	KWH Use After Easimount	KWH Saved	x	KWH Rate	=	\$\$\$\$ Saved
_____	_____	_____	_____	x	_____	=	_____
_____	_____	_____	_____	x	_____	=	_____
Example: 3'x7'	1,300 KWH/mo.	910 KWH/mo.	390 KWH/mo.	x	\$.08	=	\$31.20/mo.

ThermalFlex® systems protect your space

Keep heat, cold, dust, pollutants where they belong. Cut energy cost.

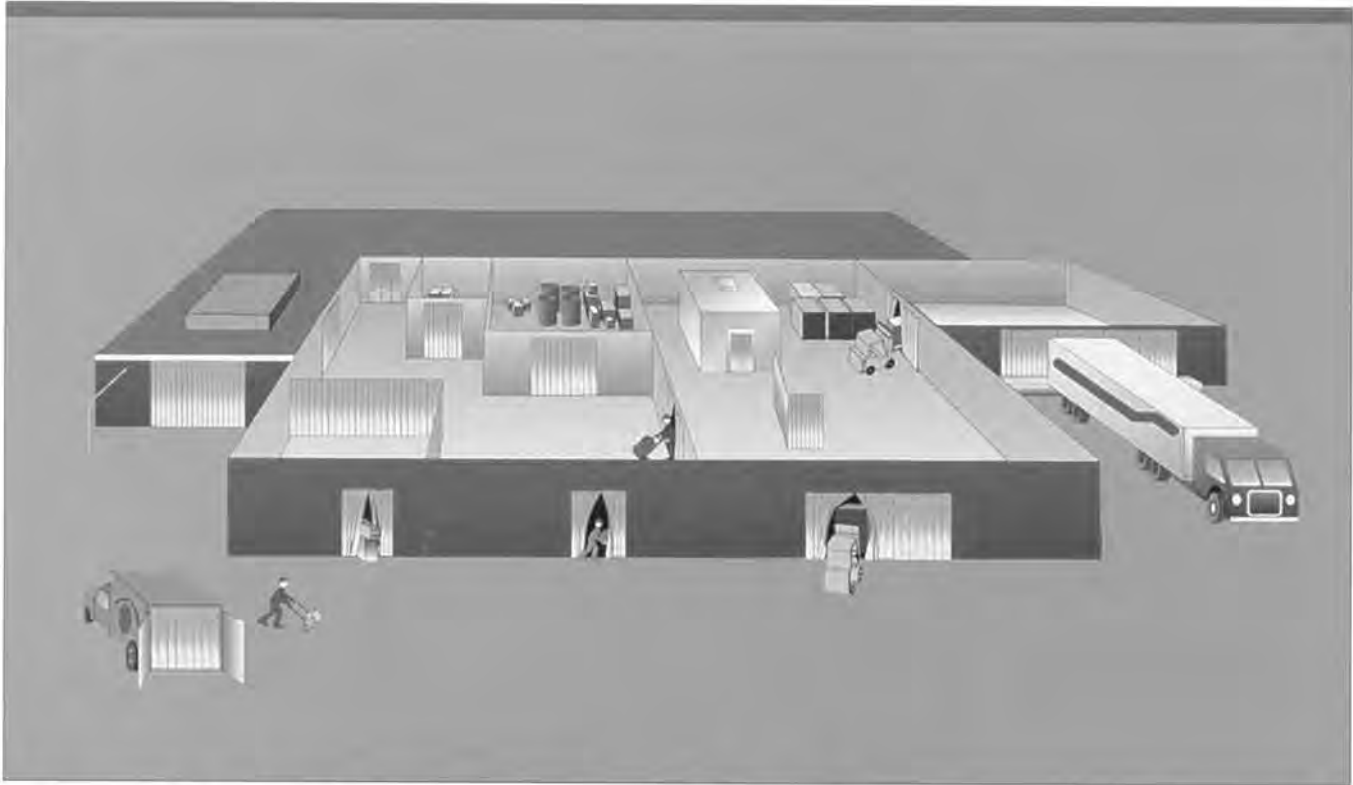

ThermalFlex® Strip Systems Applications

- | | | |
|------------------------------|--|----------------------------|
| 1. Walk-in Coolers, Freezers | 6. Machine enclosures | 11. Electronics enclosures |
| 2. Storage area enclosures | 7. Drive-through doors | 12. Reefer doors |
| 3. Loading dock doors | 8. Conveyor openings | 13. Traffic doors |
| 4. Personnel doors | 9. Craneway enclosures | 14. Spray booth partitions |
| 5. Room partitions | 10. Polishing or sanding area curtains | 15. Welding curtains |

The Strip Door Advantage.

- ◆ Reduce energy loss up to 50%, when used with standard doors.
- ◆ Protect products and personnel, while providing easy access.
- ◆ Reduce the exchange of noise and dust.
- ◆ Extend life and reduce maintenance of HVAC and refrigeration equipment.

The ThermalFlex® Strip Door Advantage.

- ◆ Unique Easimount and Maximount systems feature slide-in strips for easy assembly and strip replacement.
- ◆ Track systems available for mounting to flush wall, side wall, ceiling, doorjamb or truck body.
- ◆ Versatile systems for light, standard and heavy duty applications.
- ◆ Wide range of industrial and USDA-approved strip materials.
- ◆ The Kason reputation for premium value, innovative products and dependable delivery.

Protect your space with
ThermalFlex® Strip Systems
for material handling, production and storage

